

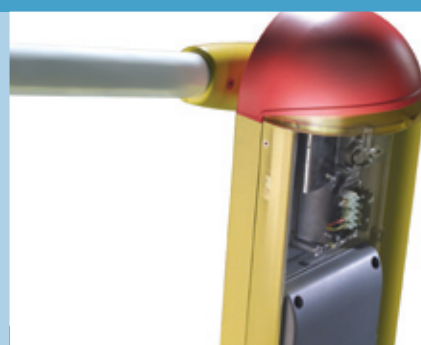

AUTOMATION FOR 3 m BARRIERS WITH A 24 Vdc MOTOR

EL
CARDIN



Motor power supply
24 Vdc

Modular structure
**Anodized aluminium "anti-corodal"
epoxide powder painted**

Duty cycle
100 %

Buffer batteries / Warning lights
incorporated

24V

EL3024

EL3024

The appliance is a complete and efficient machine "just the right size" and packed with Cardin technology: powered by direct current with deceleration in both the opening and closing directions, anti-crush safety devices and continuous operation. It is designed to protect and control entrances in domestic housing areas and it is for this reason that its form is essentially pleasing on the eye as should any urban object be which is destined to be inserted into any architectural context. The barrier, mounted on an aluminium body, uses a **60 mm** round boom with a maximum length of **3 m** and features an incorporated warning light and a buffer battery which allows the barrier to be opened and closed even during blackouts.

Easy to install it is weatherproof and fitted with all the security connections needed to carry out an automatic installation. The barrier comes complete with an electronic programmer, radio frequency decoder, battery charger and buffer batteries.

USE

The appliance may be used to control passageways with a maximum width of **3 m** and may be fitted both to the **right** and to the **left** of the passageway.

The use of low voltage motors increase the performance, guarantee high efficiency, long life, a 100% duty cycle and silent running.

The programmer features **intelligent time control functions**, which allow you to control the position of the boom with extreme precision. Monitoring the **current consumption** allows the control of a sophisticated anticrush safety system and with the "**soft start**" and "**soft stop**" functions reduce the stress on the mechanical components.

The work cycle times are stored under non volatile EEPROM.

aluminium structure

incorporated warning lights

manual release

integrated electronics

programming

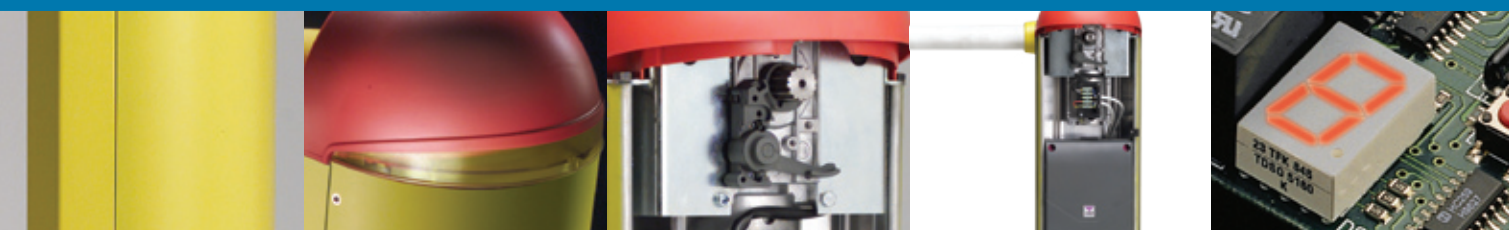

TECHNICAL SPECIFICATIONS

Model	Mains power supply	Electrical input	Power input	Duty cycle	Opening time (90°)	Torque	Maximum boom length	IP
EL3024	Vac 230	A 1	W 220	% 100	s 5	Nm 80	m 3	54
Motor data:	Motor power supply		Maximum power yield		Electrical input			
	Vdc 24...38		W 60		A 1,5			
Incorporated receiver card:	Reception frequency		Nr. of user codes		Nr. of channels		Nr. of functions	
	MHz 433,92		300		4		1	

TECHNICAL DESCRIPTION

- Direct current motor with a steel never ending screw;
- Geared motor with steel gears enclosed in a die cast two-piece aluminium shell;
- Carter in shock-proof plastic;
- Manual release components in reinforced plastic;
- Motor support base in zinc-plated steel;
- Boom holder in die cast aluminium;
- Lubrication using permanently fluid grease;
- Barrier cabinet in spray painted die cast aluminium;
- Incorporated warning light.

VERSIONS

- 710/EL3024 Automation for barriers with a direct current motor complete with an electronic programmer containing an S449 quartz receiver in "FM", buffer batteries with a battery charger, automatic and semiautomatic functions and a torque limiter.

ACCESSORIES

- 716/EL3024A Ø60 mm - 3 m long boom complete with boom holder arm with which to connect it to the barrier.
- 716/EL3024FS Fixed position boom support fork in aluminium.

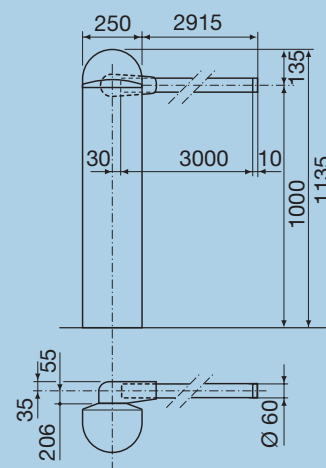

INSTALLATION EXAMPLE

Legend

- Barrier
- Electronic programmer
- Photocells
- All pole circuit breaker with a min. of 3 mm between the contacts
- 1200 mm column for a selector switch or an SSB-T9K4
- Sensitive magnetic loop
- Fixed support fork

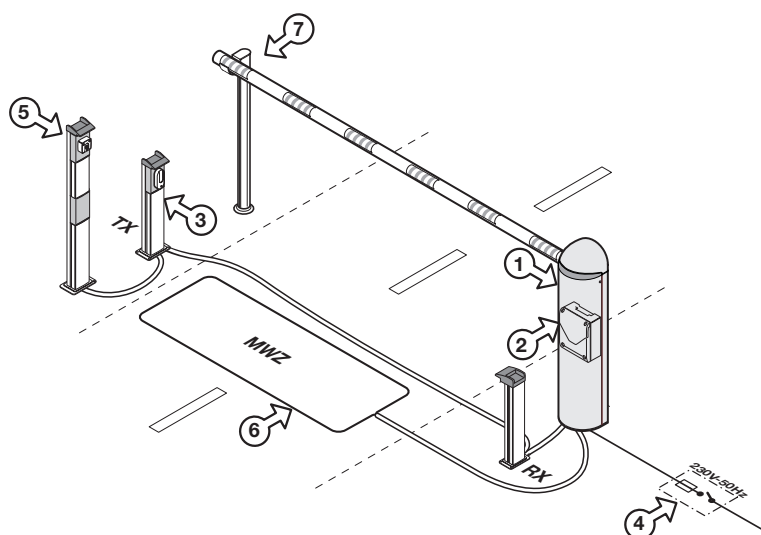

CARDIN ELETRONICA spa

Via Raffaello, 36- 31020 San Vendemiano (TV) Italy
 Tel: +39/0438.404011 - 401818
 Fax: +39/0438.401831
 E-Mail (Italy): Sales.office.it@cardin.it
 E-Mail (Europe): Sales.office@cardin.it
 Http: www.cardin.it